

F06-06-390 (L16)

Flooded Deep Cycle Battery

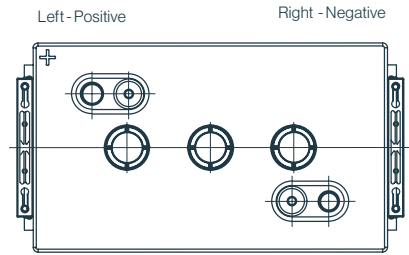
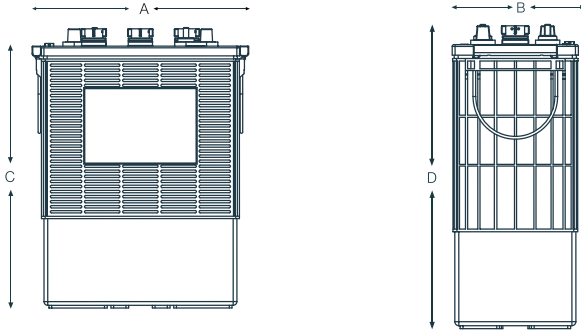
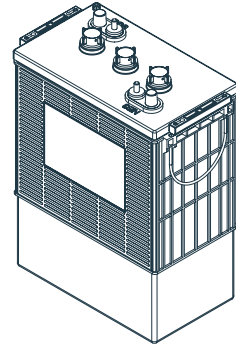

Electrical Specifications

| | |
|--------------------------------|--|
| C5 Capacity | 320Ah |
| C20 Capacity | 390Ah |
| Voltage | 6V |
| 80% DOD Voltage Cutoff | 5.6V |
| Self Discharge | Less than 3% per month (20°C/68°F) |
| Charge Temperature | Min: -10°C (14°F) / Max: 50°C (122°F) |
| Discharge Temperature** | Min: -40°C (-40°F) / Max: 50°C (122°F) |
| Storage | Min: -20°C (-4°F) / Max: 60°C (140°F) |

Features

- Flooded bloc batteries

- Good high current performance for extreme operating conditions

- 1000 cycles (IEC 60254)

- Recyclable

- Long cycle life

- Low self discharge rate

Mechanical Specifications

| | | |
|---------------------------|-----------|--------|
| Industry Reference | - | |
| Length (A) | 12.1in | 308 mm |
| Width (B) | 6.9in | 174 mm |
| Height (C) | 15.3in | 388 mm |
| Height (D) | 16.4in | 416 mm |
| Weight | 105.8 lbs | 48 kgs |
| Terminal (Opt'l) | Dual | |
| Cell(s) | 3 | |
| Electrolyte | Flooded | |
| Terminal Torque Nm | 8 | |

NOTE: There is a tolerance of +/-2%.

Dual

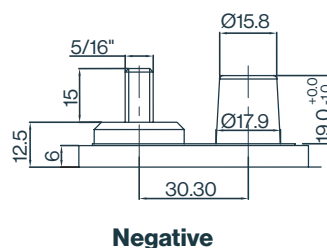
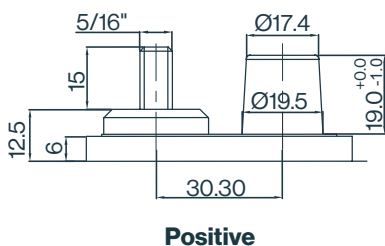

All applications including:

- Cleaning Machines

- Aerial Platforms & Lifters

- Pallet Trucks

- Golf Carts